

ARCHIE

INSTALLATION MANUAL

E26 / E27 (120V/220V)
Incandescent 100w max
PLE-T Eco 42w max

1.

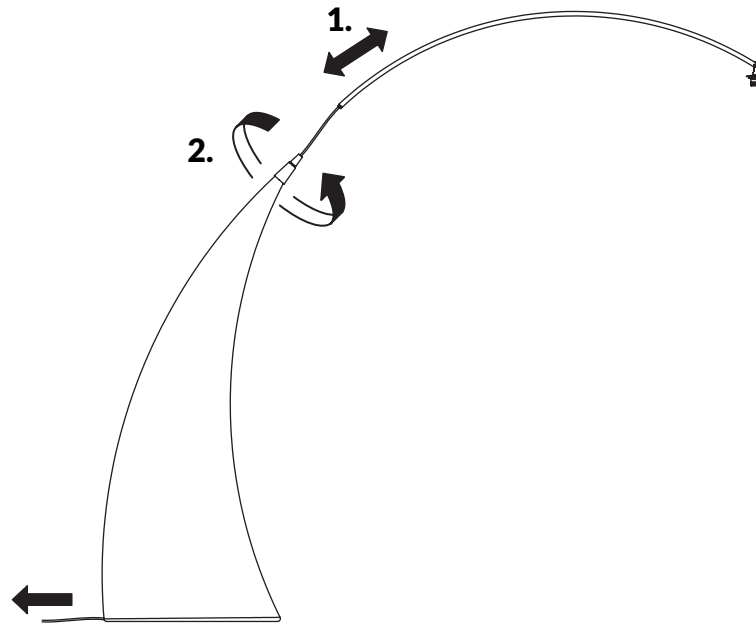

2.

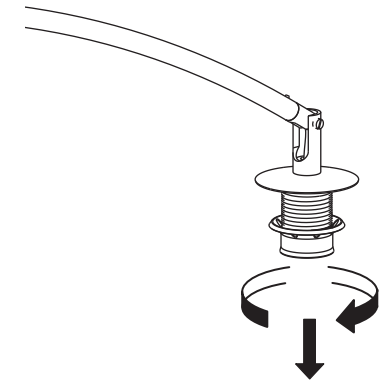

3.

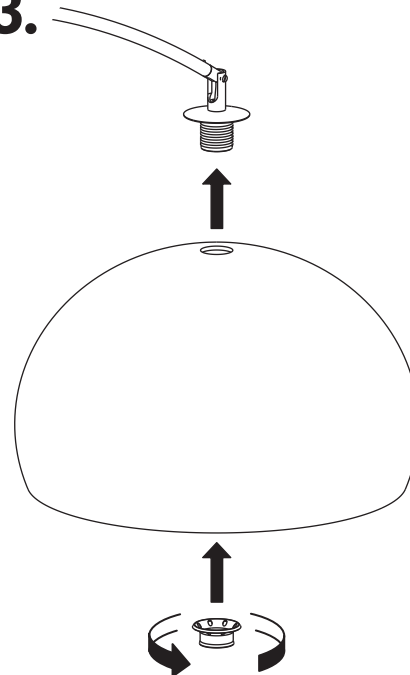

4.

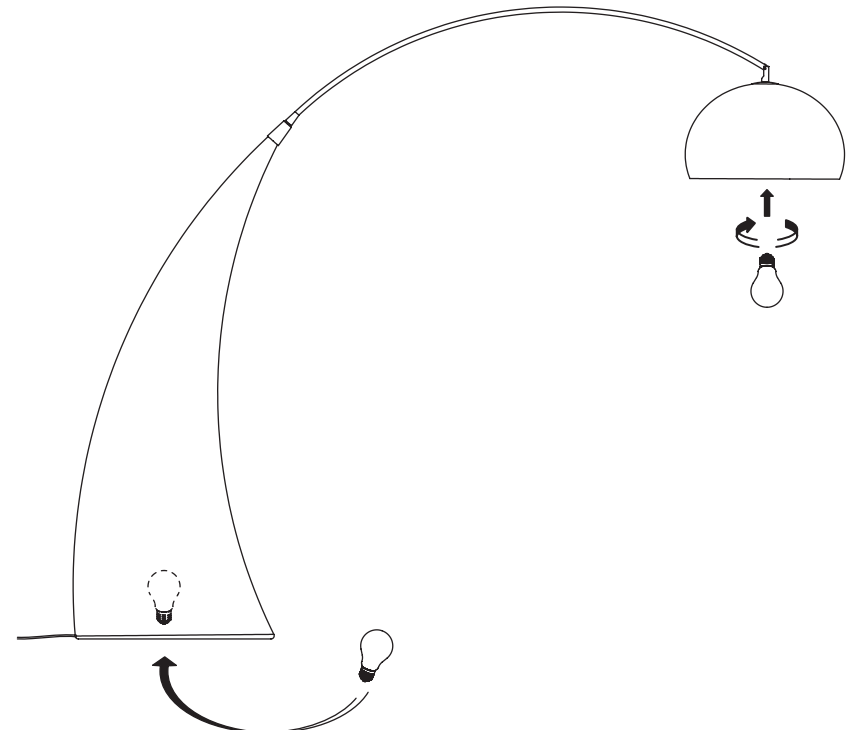

IMPORTANT

Always shut off power to the circuit
before starting installation work.



All products are manufactured to meet
or exceed North American standards
C22.2-250, UL 1598, C22.2-12, C22.2.9,
UL 153.

All preparation for installation of fixture
is to be provided by the end user.

The description and measurements on
this drawing are for information
purposes only.

VISO inc // © 2014 // All rights reserved